



# WELCOME

## WORTHING HIGH SCHOOL OPEN DAY

Saturday 20 September 2025



Worthing High School is part of the South Downs Educational Trust



'Outstanding Leadership'  
'Very Effective Teaching'

# THE WORTHING WAY

## CORE VALUES



Always Pursue Excellence semper ad excellentiam contende

EDUCA110N  
TRUST



# CONTENTS

<b>Page 4-5</b>	<b>WELCOME</b> <ul style="list-style-type: none"><li>- CEO OF SOUTH DOWNS EDUCATION TRUST</li><li>- HEADTEACHER</li></ul>
<b>Page 6-9</b>	<b>TODAYS PROGRAMME OF EVENTS FROM THE CURRICULUM</b>
<b>Page 10</b>	<b>SCHOOL INFORMATION</b>
<b>Page 10</b>	<b>EXTRA CURRICULAR ACTIVITIES</b>
<b>Page 12 - 13</b>	<b>WHS SCHOOL MAP</b>
<b>Page 14</b>	<b>WHS SENIOR STAFF</b>
<b>Page 15</b>	<b>OPEN MORNING DATES - BOOKING</b>
<b>Page 16</b>	<b>ENRICHMENT AT WHS</b>
<b>Page 18</b>	<b>TRANSITION FROM YEAR 6 TO YEAR 7</b>
<b>Page 19</b>	<b>SUMMER SCHOOL</b>
<b>Page 20</b>	<b>2025 EXAM RESULTS</b>
<b>Page 21</b>	<b>UNDERSTANDING THE PERFORMANCE INDICATORS</b>
<b>Page 22</b>	<b>ADMISSIONS INFORMATION</b>
<b>Page 23</b>	<b>OUR ADMISSIONS AREA</b>





# CEO - SOUTH DOWNS EDUCATION TRUST WELCOME

I would like to personally welcome you and your family to our annual Open Day. The event will give you a great insight into students' learning opportunities at Worthing High School.

Worthing High is a very popular, successful, oversubscribed school. The school is founded on our Core values: Integrity, Community, Excellence, Respect Resilience and Wellbeing. All students in our community have the right to learn and thrive in an environment which is calm, safe secure and challenging. This ensures that all students reach their full potential.

The Headteacher's presentations, are at 10.00 and 11.00am in the Millennium Hall.

Tickets to the Headteacher's presentation should be pre-booked on Ticket Source and you need to collect your tickets from the Millennium Hall lobby, to then show your tickets to enter.

"We very much look forward to meeting you and your child and showing you our amazing school."

**Pan Panayiotou**

Executive Headteacher  
CEO - South Downs Education Trust





# HEADTEACHER WELCOME FOR OPEN DAY

**On behalf of our staff and students, I am proud to welcome you to our school for our annual Open Day event.**

Worthing High School has high ambition for all of its students and staff will go above and beyond to get the best out of your child, both inside and outside of the classroom. Students are challenged to do their very best, regardless of their starting point and will enjoy a broad and balanced curriculum that will help them develop the knowledge and skills needed for twenty-first century life.



“Please have a good look around, ask lots of questions and enjoy your visit. We hope you leave with a good feel for our school.”

**Adrian Cook**

Headteacher





# TODAYS PROGRAMME OF EVENTS FROM THE CURRICULUM



Subject Areas are colour coded as a guide to the event's location within the School. Please use the Map on pages 12 & 13 to locate the event you have chosen to visit.

**Presentations will take place in the Millennium Hall at 10.00am and 11.00am.**

The following events run throughout the day.

Subject Area	Room	Activity
Art	F9 & F10	F9 - Autumn Colour Collage F10 - Clay modelling
Computer Science	D4	- Raspberry Pis - Scratch programming - Python programming
Design Technology	C8	Design and Technology - Make your own phone holder
Food Preparation and Nutrition	T5	- Year 10 GCSE students demonstrating some healthy recipes - Sensory analysis: what ingredients can you recognise? Are you a Master Chef?
Drama	D8 (Drama Studio)	- Create your own stage design

Subject Area	Room	Activity
English	E11	- Match the character to the classic text Quiz - Interactive word games
Media Studies	B6	- Logo Quiz - Video games industry
Geography	B11	- Play dough models of geographical features - Can you match the place to the description? - Making pet tornadoes - Lego landmarks - Map mistakes
History	E7	- Who is the mystery historical person? Prizes to be won - Matching games - Artefact treasure trove from Worthing Museum
Inclusion Team	F2	- Teachers available for parents to discuss their children's particular learning needs and possible provision - Displays of learning activities
Learning Resource Centre	LRC	- Guess which book characters are coming to dinner! - Information on Accelerated Reader and our reading programmes, author events and literacy activities
Maths	M4 & M5	- Interactive maths games - Challenge activities and puzzles - Competitions



# TODAYS PROGRAMME OF EVENTS FROM THE CURRICULUM



Subject Areas are colour coded as a guide to the event's location within the School. Please use the Map on pages 12 & 13 to locate the event you have chosen to visit.

Subject Area	Room	Activity
Modern Languages (MFL)	D13	<ul style="list-style-type: none"> <li>- Examples of marked work separated into Key Stage 3/Key Stage 4</li> <li>- Interactive language games</li> <li>- Music</li> <li>- Spanish and French food tasting</li> </ul>
Music	D14 Canopy	<ul style="list-style-type: none"> <li>- Student performances and compositions</li> <li>- 'B Sharp Guitar School' performances</li> </ul>
Physical Education  Dance	Sports Hall  Glynn Owen Centre  Dance Studio	<ul style="list-style-type: none"> <li>- Come and test your fitness and skill levels</li> <li>- Sports activities</li> <li>- Dance workshops - have a go at different dance styles</li> </ul>
Philosophy and Ethics	D7	<ul style="list-style-type: none"> <li>- Big questions</li> </ul>

Subject Area	Room	Activity
Textiles	T2	- Felt keyring
Science	C5	<p style="text-align: center;"><b>BIOLOGY</b></p> <ul style="list-style-type: none"> <li>- Dissections</li> <li>- Scientific models</li> <li>- Extracting DNA</li> <li>- Mirror tracing</li> <li>- Microscopes and slides</li> <li>- Food tests</li> </ul>
	C6	<p style="text-align: center;"><b>CHEMISTRY</b></p> <ul style="list-style-type: none"> <li>- Acids and alkalis</li> <li>- Flame tests</li> <li>- Chromatography</li> <li>- Squeaky pop</li> <li>- Rainbow fizz</li> </ul>
	C7	<p style="text-align: center;"><b>PHYSICS</b></p> <ul style="list-style-type: none"> <li>- Bending light</li> <li>- Air track and inertia</li> <li>- Measuring acceleration</li> <li>- Electrical circuits</li> <li>- Floating ping pong balls</li> <li>- Mini hover crafts</li> <li>- Vortex cannon</li> </ul>
DofE - Forest School - APU	E13	- Outdoor Education and Displays



# SCHOOL INFORMATION AND EXTRA CURRICULAR ACTIVITIES

## OTHER INFORMATION

Samples available in the canteen from 9.00am – 12.30pm  
by our catering provider PS Catering Management Ltd.

Tea, coffee and squash provided by Worthing High  
School

### IN THE CANTEEN

- Clapham and Patching Primary School
- Governor/Trustee/Parent Forum
- FOWHS (Friends of Worthing High School)
  - Admissions Information
  - School Uniform Display
  - Challenging the most able
    - STEAM
- Year 6 Summer School in August 2025
- Train to Teach at Worthing High School

### LIFE OUTSIDE THE CLASSROOM

- Careers and future paths
- More Able programme
  - Enrichment
- Duke of Edinburgh Award
- Forest School (also at the Glynn Owen Centre)
  - Alternative Provision
    - PGL Trip
  - Community and Charity



Subject Areas are colour coded as a guide to the event's location within the School. Please use the Map on pages 12 & 13 to locate the event you have chosen to visit.





# WORTHING HIGH SCHOOL MAP

Worthing High School  
South Farm Road  
Worthing  
West Sussex  
BN14 7AR

Tel: 01903 237864

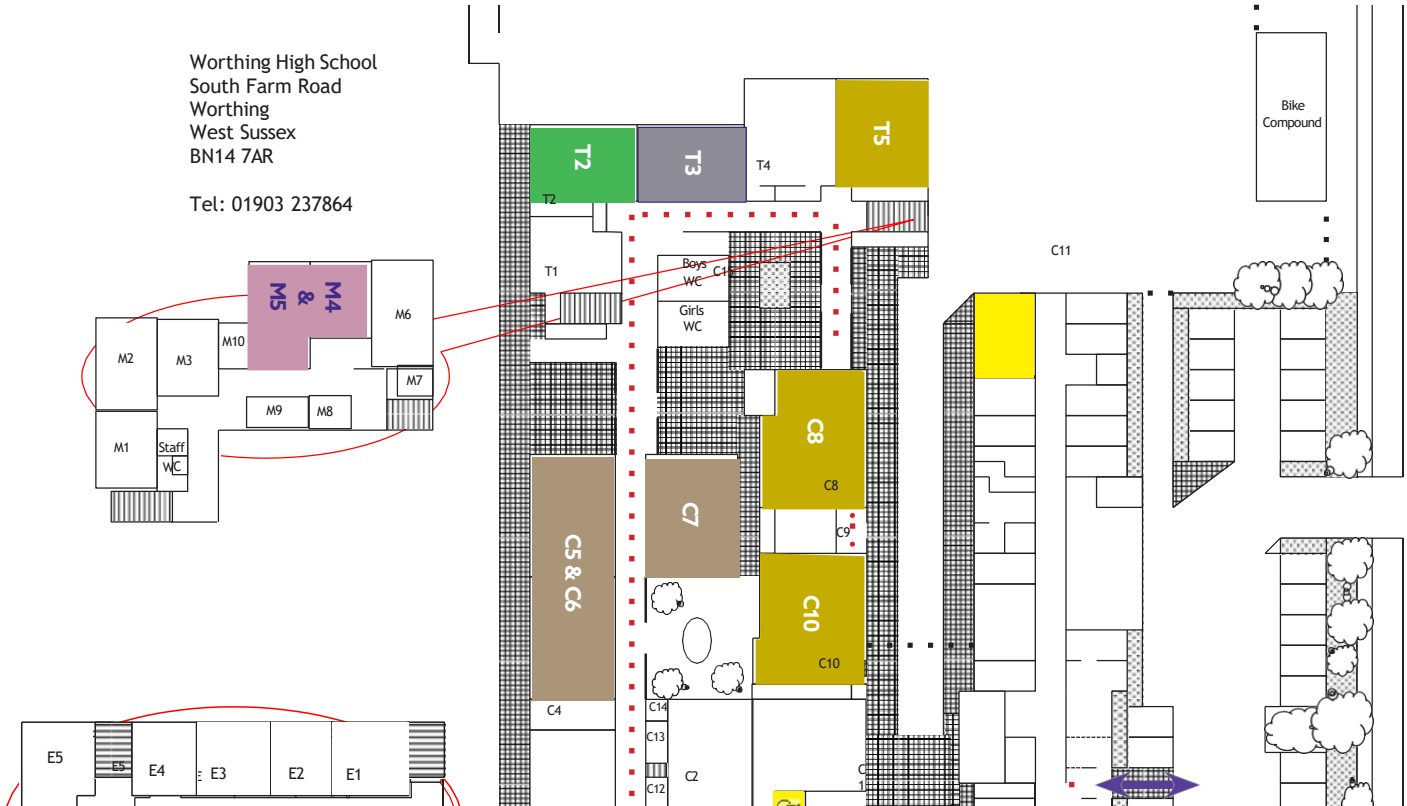

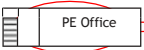
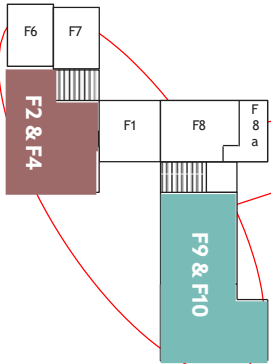
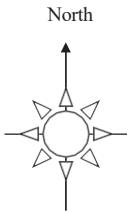
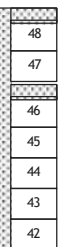
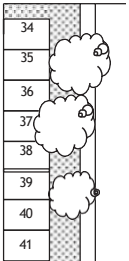
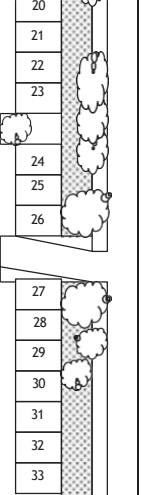

Visitor Toilets



Disabled Toilets



Corridor-Tour Route



First Floor Classrooms

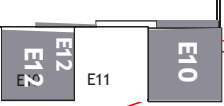
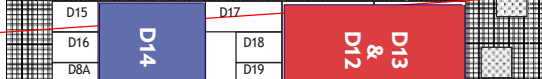
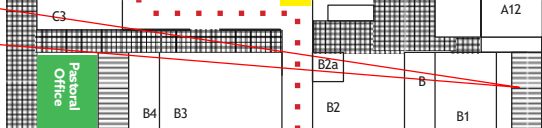
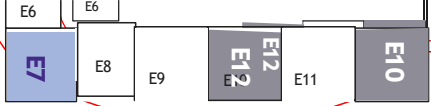



# WORTHING HIGH SCHOOL SENIOR STAFF



Subject Areas are colour coded as a guide to the event's location within the School. Please use the Map on pages 12 & 13 to locate the event you have chosen to visit.

CEO South Downs Education Trust	Mr P. Panayiotou	
Chair of Trustees	Mr R. Cohen	
Chair of Governors	Mrs L Davey	
Headteacher	Mr A. Cook	
Deputy Headteacher	Mr S. Swift	
Deputy Headteacher	Mr A. Simpson	
Assistant Headteacher (DSL)	Mr N. Mariosa	
Assistant Headteacher	Mrs E. Hopkins	
Assistant Headteacher	Ms C.Vilday	
Assistant Headteacher	Mrs H. Thomson	
Chief Financial Operations Officer	Mrs S. Jones	
Progress Leaders:	Year 11 - Mr R. Morris	
	Year 10 - Mrs E. Kundishora	
	Year 9 - Mr S. Townsend	
	Year 8 - Mr R. Mashford	
Year 7 - Mrs C. Farrell		
<b>SUBJECT LEADERS</b>		
Subject Leader - English	Miss H. Davies	E11
Subject Leader - Maths	Ms A. Fallahi	M4 and M5
Subject Leader - Science	Mr A. Kent	C7
Leader of Inclusion & SENCO	Mrs E. Willett & Mrs E. Allen	F2
Modern Foreign Languages	Mrs H. Varley	D12
Design Technology	Mr K. Rasarathnam	C8
Art	Ms M. Hunt	F9 and F10
Physical Education	Miss M. Field	Sports Hall
Music	Mr D. Martin	D14
Computing/ICT	Mrs T. La	D4
History	Mr J. Oram	E7
Geography	Mrs C. Glover	B10
Religious Education	Mr R. Mashford	D7
Drama	Mrs J. Batchelor	D8
Dance	Miss A. Strudwick	Dance Studio
Media	Mrs N. Hoad	B6



# VISIT OUR AMAZING SCHOOL OPEN MORNING TOUR DATES



**Monday 22 September**

**Tuesday 23 September**

**Wednesday 24 September**

**Thursday 25 September**

Tours from 09.15am –  
11.00am on the above days

**Pre-booking necessary**

If these dates and times are not convenient, please contact us for an alternative day and time.

**Tel: 01903 237864**

**Email:  
office@worthinghigh.net**

Parents/Carers can  
book online at:

[www.ticketsource.co.uk  
/worthing-high-school](http://www.ticketsource.co.uk/worthing-high-school)



Worthing High School is part of the South Downs Educational Trust

 **@worthinghigh**



# ENRICHMENT AT WORTHING HIGH SCHOOL







# TRANSITION FROM YEAR 6 TO YEAR 7



Transition to Worthing High School is a fundamental part of your child's progression. Our Progress Leaders liaise with all feeder schools throughout the year. Your child will meet their new progress leader during an assembly this term.

If you choose Worthing High, you will have an opportunity during the year to inform us about your child. This will be in addition to a detailed meeting between your child's class teacher, their progress leader and our Pastoral Leaders to discuss all aspects of learning support.

Year 6 'Transition days' will occur during June/July 2026. Individual tailored visits to Worthing High School will be arranged, where extra support is needed.



Mr Richard Morris  
Progress Leader



Mr Jenifer Rhodes  
Pastoral Leader



## 2025 SUMMER SCHOOL

**Worthing High run an annual Transition Summer School in August. It is a fantastic opportunity for new Year 7 students to find their way around the school, make new friends and develop key team building and problem-solving skills, all whilst having a great time.**

**During the week, the children will take part in a vast range of enrichment activities including school orientation, problem solving, drama, art, cooking and many more. They will also participate in discussion sessions to help support their transition to secondary school.**

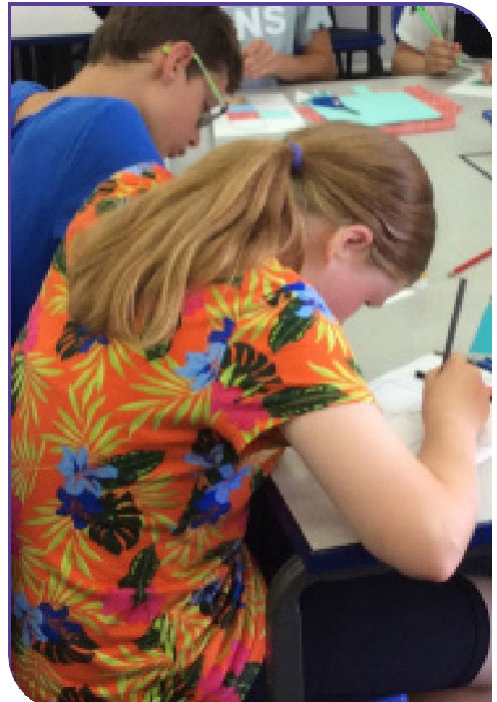



# 2025 EXAM RESULTS

## Worthing High School Results by Subject

The Government's threshold for a 'pass' in all subjects is a grade 4 or equivalent. Below is a comparison between Worthing High School's pass rate in all subjects we offer where there is a national comparison. Worthing High school is above the national average in both English and Mathematics as well as all humanities and languages.

Subject	% Grade 4 (Pass)	
	National data	WHS Data
Art	76.9	80
Biology	90.4	92
Chemistry	91.9	90.5
Science: Double Award	57.6	56
Computing	69.2	71.4
DT	66.7	78.4
Drama	77.6	94.7
English Language	70.6	73.4
English Literature	74.2	77.7
Food Preparation	68.4	90.7
French	72.5	92.9
Geography	65.1	76.5
German	79.1	89.2
History	64.2	75.4
Mathematics	71.9	81.5
Media	69.8	70.6
PE	72.8	100
Physics	91.2	92.1
Philosophy and Ethics	72.6	76.9
Spanish	70.1	78.8
Statistics	67.6	98.7



# 2025 EXAM RESULTS





# ADMISSIONS INFORMATION

## Our Admissions Policy

Worthing High School is a 11-16 mixed comprehensive school and one of five secondary schools in the town of Worthing.

We became an Academy on 1 December 2012 and have a non-selective policy.

The main principle of admission to Worthing High School is to maintain the character of the school as a comprehensive school with a calm and purposeful learning ethos, providing for the needs of young persons within the 11-16 age range, who live in Worthing and the surrounding areas.

There is no guarantee of a place for children living in this area in the case of oversubscription.

We are an inclusive school with a family feel and welcome all applications. Our uniform policy is intended to encourage a professional appearance and a pride in the school. We have tried to keep this at a reasonable cost while maintaining a level of conformity and are pleased to discuss any concerns you may have about uniform items.

Admission to our school is not dependent on any voluntary contribution and we have a full range of extra-curricular activities available for all students at no cost. We also have a full programme of both residential and non-residential visits for which a charge is made but again are pleased to discuss any concerns you may have.

- Pupils will be admitted at the age of 11+ without reference to ability or aptitude.
- The admission number for September 2026 will be 210 for any year group.
- Mid-year admissions into Years 8,9,10 and 11 will be dealt with in accordance with this policy.

Our catchment area is the borough of Worthing.

## How to apply:

<http://www.worthinghigh.net/admissions/>



# 2025 - OUR ADMISSIONS AREA

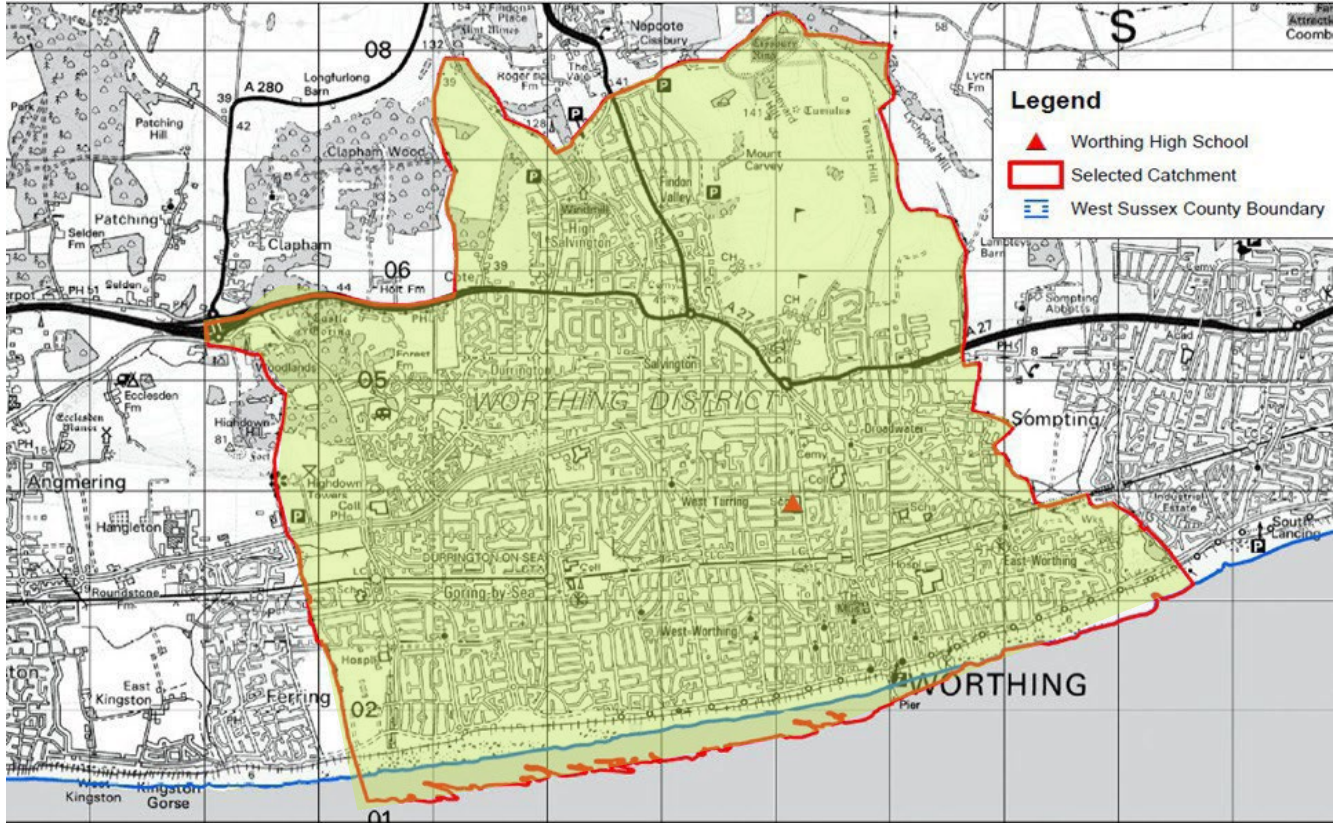

**COMMUNITY - EXCELLENCE - RESILIENCE - INTEGRITY - RESPECT**

**Worthing High School**

**South Farm Road, Worthing, West Sussex, BN14 7AR**

**Tel: 01903 237864**

**Email: [office@worthinghigh.net](mailto:office@worthinghigh.net)**

**Website: [www.worthinghigh.net](http://www.worthinghigh.net)**



Worthing High School is part of the South Downs Educational Trust