



# WELCOME

## WORTHING HIGH SCHOOL OPEN DAY

Saturday 24 September 2022



Worthing High School is part of the South Downs Educational Trust



'Outstanding Leadership'  
'Very Effective Teaching'

# THE WORTHING WAY

## CORE VALUES

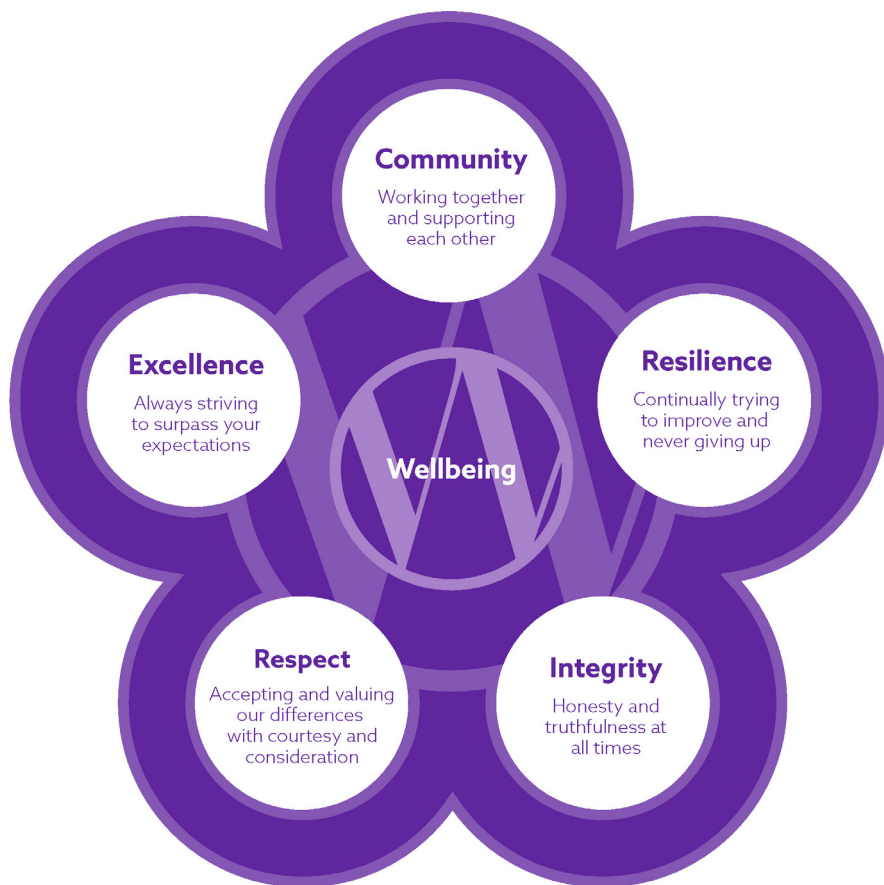

Always Pursue Excellence semper ad excellentiam contende





# CONTENTS

<b>Page 4-5</b>	<b>WELCOME</b>
	- WHS EXECUTIVE HEADTEACHER
	- WHS HEAD OF SCHOOL
<b>Page 6-9</b>	<b>TODAYS PROGRAMME OF EVENTS FROM THE CURRICULUM</b>
<b>Page 10</b>	<b>SCHOOL INFORMATION</b>
<b>Page 10</b>	<b>EXTRA CURRICULAR ACTIVITIES</b>
<b>Page 12</b>	<b>WHS SCHOOL MAP</b>
<b>Page 14</b>	<b>WHS SENIOR STAFF</b>
<b>Page 15</b>	<b>OPEN MORNING DATES - BOOKING</b>
<b>Page 16</b>	<b>ENRICHMENT AT WHS</b>
<b>Page 18</b>	<b>TRANSITION FROM YEAR 6 TO YEAR 7</b>
<b>Page 19</b>	<b>SUMMER SCHOOL</b>
<b>Page 20</b>	<b>2022 EXAM RESULTS</b>
<b>Page 21</b>	<b>UNDERSTANDING THE PERFORMANCE INDICATORS</b>
<b>Page 22</b>	<b>ADMISSIONS INFORMATION</b>
<b>Page 23</b>	<b>OUR ADMISSIONS AREA</b>





# EXECUTIVE HEADTEACHERS WELCOME

I would like to personally welcome you and your family to our annual Open Day. The event will give you a great insight into students' learning opportunities at Worthing High School.

Worthing High is a very popular, successful, oversubscribed school. The school is founded on our **Core values: Integrity, Community, Excellence, Respect Resilience and Wellbeing.** All students in our community have the right to learn and thrive in an environment which is calm, safe secure and challenging. This ensures that all students reach their full potential.

**The Headteacher's presentations, are at 09.30, 10.30 and 11.30am in the Millennium Hall.**

**Tickets to the Headteacher's presentation should be pre-booked on Eventbrite and you need to collect your tickets from the Millennium Hall lobby, to then show your tickets to enter.**

"We very much look forward to meeting you and your child and showing you our amazing school."

**Pan Panayiotou**

Executive Headteacher  
CEO - South Downs Education Trust





# HEAD OF SCHOOL WELCOME FOR OPEN DAY

On behalf of our staff and students, I am proud to welcome you to our school for our annual Open Day event.

Worthing High School has high ambition for all of its students and staff will go above and beyond to get the best out of your child, both inside and outside of the classroom. Students are challenged to do their very best, regardless of their starting point and will enjoy a broad and balanced curriculum that will help them develop the knowledge and skills needed for twenty-first century life.

"Please have a good look around, ask lots of questions and enjoy your visit. We hope you leave with a good feel for our school."

**Adrian Cook**

Head of School





# TODAYS PROGRAMME OF EVENTS FROM THE CURRICULUM



Subject Areas are colour coded as a guide to the event's location within the School. Please use the Map on pages 12 & 13 to locate the event you have chosen to visit.

**Presentations will take place in the Millennium Hall  
at 09.30am, 10.30am and 11.30am.**

The following events run throughout the day.

Subject Area	Room	Activity
Art	F9 & F10	F9- Sea themed mono-printing F10 - Clay modelling
Computer Science	D4	- Raspberry Pis - Scratch programming - Python programming
Design Technology	C10	<b>Design and Technology</b> - Make your own phone holder - Laser demonstration
	C8	<b>Design and Technology</b> - 'Vacuum Form' your initials or name
Food Preparation and Nutrition	T5	- Year 10 GCSE students demonstrating some healthy recipes - Sensory analysis: what ingredients can you recognise? Are you a Master Chef?
Drama	D8 (Drama Studio)	- Create your own stage design

Subject Area	Room	Activity
English	E3	- 'Match the character to the classic text' Quiz – Interactive word games
Media Studies	B6	- Logo Quiz - Lideo games industry
Geography	B10	- Play dough models of geographical features - Can you match the place to the description? - Making pet tornadoes - Lego landmarks
History	E7	- Who is the mystery historical person? <b>Prizes to be won</b> - Matching games - Artefact treasure trove from Worthing Museum
Inclusion Team	F2 & F4 Office	- Teachers available for parents to discuss their children's particular learning needs and possible provision - Displays of learning activities
Learning Resource Centre	LRC	- Guess which book characters are coming to dinner! - Information on Accelerated Reader and our ready programmes, author events, literacy activities and parent library
Maths	M5 M6	- Interactive maths games - Challenge activities and puzzles - Competitions





# TODAYS PROGRAMME OF EVENTS FROM THE CURRICULUM



Subject Areas are colour coded as a guide to the event's location within the School. Please use the Map on pages 12 & 13 to locate the event you have chosen to visit.

Subject Area	Room	Activity
Modern Languages (MFL)	D6 French	<ul style="list-style-type: none"> <li>- Examples of marked work separated into Key Stage 3/Key Stage 4</li> <li>- Interactive language games</li> <li>- Music</li> <li>- Spanish, German and French food tasting</li> </ul>
	D13 German	
	D12 Spanish	
Music	D14	<ul style="list-style-type: none"> <li>- Student performances and compositions</li> <li>- 'B Sharp Guitar School' performances</li> </ul>
Physical Education	Sports Hall	- Come and test your fitness and skill levels
	School Field	- Football
	Fitness Suite	- Fitness activities
Dance	Dance Studio	Dance workshops - have a go at different dance styles



Subject Area	Room	Activity
Philosophy and Ethics	D7	- Big questions
Science	C5	<ul style="list-style-type: none"> <li>- The human body</li> <li>- Red cabbage indicator</li> <li>- Mirror tracing</li> <li>- WHS Zoo</li> <li>- Dissections</li> </ul>
	C6	<ul style="list-style-type: none"> <li>- Microscopy</li> <li>- Food testing</li> <li>- Hoffman Voltameter</li> <li>- Rainbow fizz</li> <li>- Seeing sound</li> </ul>
	C7 The dark room	<ul style="list-style-type: none"> <li>- Bending light</li> <li>- Rainbows</li> <li>- Flame tests</li> <li>- Spectroscopy</li> <li>- Methane bubbles</li> </ul>
Textiles	T2	<ul style="list-style-type: none"> <li>- Tie-dying</li> <li>- Fabric monster book mark activity</li> </ul>





# SCHOOL INFORMATION AND EXTRA CURRICULAR ACTIVITIES

## OTHER INFORMATION

Tea, coffee and refreshments available in the canteen  
from 9.00am – 1.00pm  
by **Catering Academy** our catering provider



School General Information Point

Clapham and Patching Primary School

Alumni: "Where are they now?"

Governor/Trustee/Parent Forum

Admissions Information

School Uniform display

Challenging the most able

### **Life Outside the Classroom**

- Year 6 Summer School in August 2023
  - Careers
  - Google
  - More Able programme
- Child Development and Babysitting
  - Enrichment
- Duke of Edinburgh Award
  - PGL Trip September
- Community and Charity work showcase



Subject Areas are colour coded as a guide to the event's location within the School. Please use the Map on pages 12 & 13 to locate the event you have chosen to visit.

## LOCATION

Canteen

B9





# WORTHING HIGH SCHOOL MAP

Worthing High School  
South Farm Road  
Worthing  
West Sussex  
BN14 7AR

Tel: 01903 237864

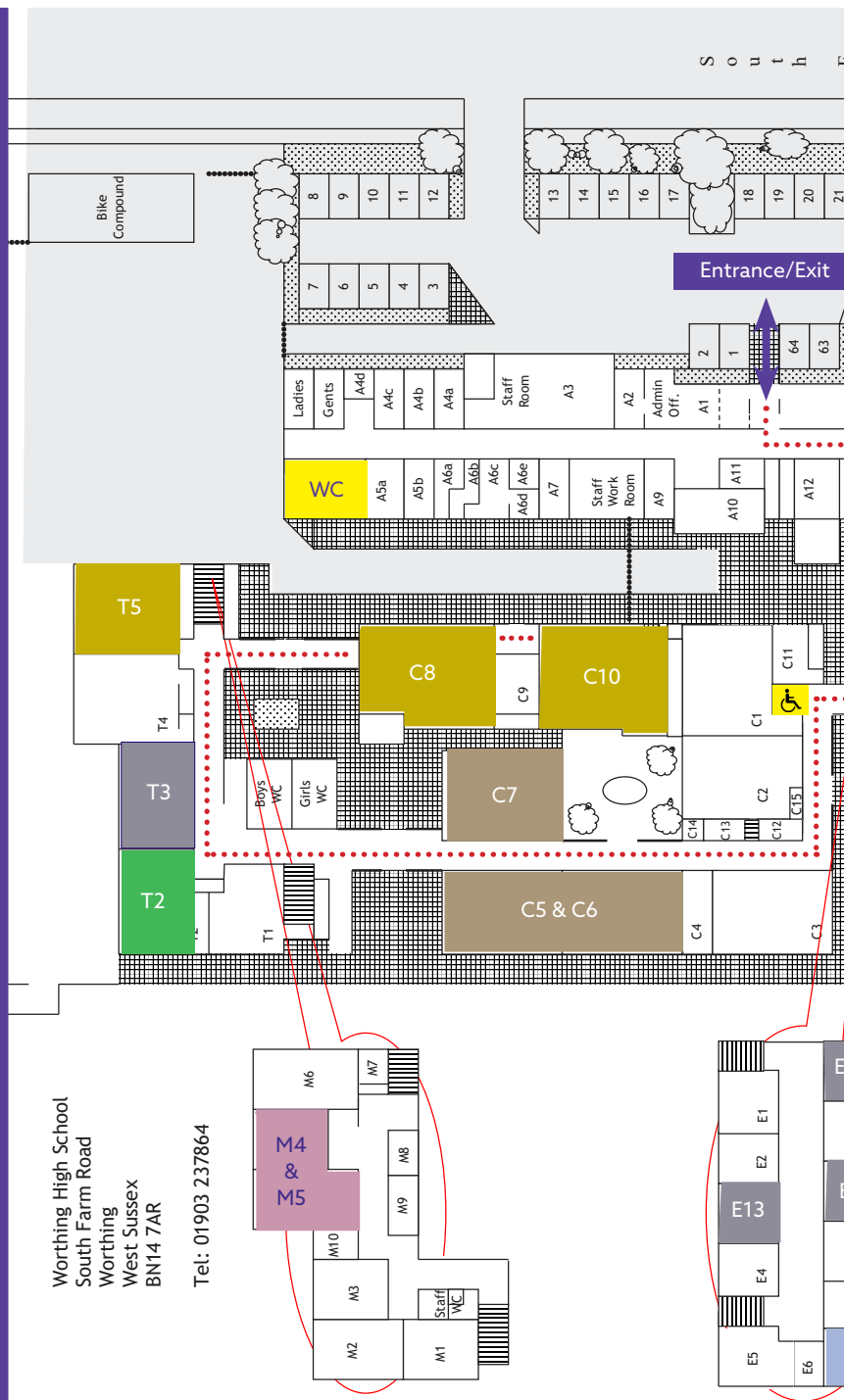

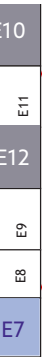



# WORTHING HIGH SCHOOL

## SENIOR STAFF



Senior Staff are colour coded as a guide to their location within the School. Please use the Map on pages 0-0 to locate the event you have chosen to visit.

CEO SDET & Executive Headteacher	Mr P. Panayiotou	
Chair of Trustees	Mr R. Cohen	
Chair of Governors	Mrs S. Scambler	
Head of School	Mr A. Cook	
Deputy Headteacher	Mr S. Swift	
Assistant Headteacher	Mr M. Smith	
Assistant Headteacher	Mr N. Mariosa	
Assistant Headteacher	Mrs E. Hopkins	
Assistant Headteacher (DSL)	Mr A. Simpson	
Operations Director	Mrs S.Jones	
Progress Leaders:	Year 11 - Mrs J. Petrie	
	Year 10 - Mr R. Mashford	
	Year 9 - Mr M. Beda	
	Year 8 - Mr R. Morris	
	Year 7 - Mr S. Townsend	
SUBJECT LEADERS		
Subject Leader - English	Mr M. Micaiah	E3/E12
Subject Leader - Maths	Mrs G. Carswell	M4/5/6
Subject Leader - Science	Mr T. Izod	C7
Leader of Inclusion & SENCO	Mr A. Simpson	F2
Modern Foreign Languages	Mr M.Beda	D6
Design Technology	Mr K. Rasarathnam	C10
Art	Ms M. Hunt	F9 and F10
Physical Education	Miss M. Field	Sports Hall
Music	Mr D. Martin	D14
Computing/ICT	Mr S. Uddin	D4
History	Mr J. Oram	E7
Geography	Mr J. Habershon	B11
Religious Education	Mr R. Mashford	D7
Drama	Mrs J. Batchelor	D8
Dance	Miss A. Strudwick	Dance Studio
Media	Mrs N. Hoad	T3



# **VISIT OUR AMAZING SCHOOL OPEN MORNING TOUR DATES**



**Monday 26 September**  
**Tuesday 27 September**  
**Wednesday 28 September**  
**Thursday 29 September**  
**and Friday 30 September**

Tours from 09.15am –  
11.00am on the above days

**Pre-booking necessary**

If these dates and times  
are not convenient please  
contact Sophie Taylor, PA  
to the Headteacher, for an  
alternative day and time  
where possible.

**Tel: 01903 237864**

**Email:**  
**[office@worthinghigh.net](mailto:office@worthinghigh.net)**

**Parents/Carers can  
book online at:**  
**[www.worthinghigh.net](http://www.worthinghigh.net)**



Worthing High School is part of the South Downs Educational Trust

 **@worthinghigh**





# ENRICHMENT AT WORTHING HIGH SCHOOL









## TRANSITION FROM YEAR 6 TO YEAR 7



Transition to Worthing High School is a fundamental part of your child's progression. Our Progress Leader, Mr Townsend liaises with all feeder schools throughout the year. Your child will meet Mr Townsend during an assembly this term.

If you choose Worthing High, you will have an opportunity during the year to inform us about your child. This will be in addition to a detailed meeting between your child's class teacher, Mr Townsend and our Pastoral Leaders to discuss all aspects of learning and support.

**Year 6 'Transition days' will occur during June/July 2023. Individual tailored visits to Worthing High School can be arranged, where extra support is needed.**



Year 7 - Progress Leader,  
Mr Stuart Townsend



## 2023 SUMMER SCHOOL

Worthing High run an annual Transition Summer School in August. It is a fantastic opportunity for new Year 7 students to find their way around the school, make new friends and develop key team building and problem solving skills, all whilst having a great time.

During the week, the children will take part in a vast range of enrichment activities including school orientation, problem solving, drama, art, cooking and many more. They will also participate in discussion sessions to help support their transition to secondary school.





# 2022 EXAM RESULTS

## UNDERSTANDING THE PERFORMANCE INDICATORS

### PROGRESS

For the past two years, Worthing High School students have made outstanding progress. On average, a Worthing High School student will achieve around one third of a grade better than the National expectation.

INDICATOR	Worthing High School students	All students nationally
% grade 4+ in English & Maths	77%	71%
% grade 5+ in English & Maths	56%	51%
Average GCSE grade	5.1	4.9
Average EBACC grade	4.7	4.4
Progress 8 score	0.3	0
% grade 4+ in English	86%	N/A
% grade 4+ in maths	81%	N/A

This means, students attending Worthing High School are more likely to be accepted into their first choice college, apprenticeship or training destination.

### Progress 8:

This measure shows how much progress Worthing High students make by the end of Key Stage 4. A score of zero indicates they are achieving the national progress target, as set by the Government. Any score above zero indicates they are doing better than expected.

### Attainment 8:

This measure shows the average total points scored by students for the 8 subjects they have done best in, including English and Maths. Each subject is graded 1–9 with English and Maths double counted.

ATTAINMENT

Worthing High School results by subject

Worthing High School is above National average across the majority of all curriculum areas; including all of the core subjects, EBacc subjects, the Arts and Technology.

Subject	% Worthing High students achieving at least a standard pass (Grade 4 or above)
Art (GCSE)	88.1%
Biology (GCSE)	100%
Chemistry (GCSE)	100%
Computing (GCSE)	85.71%
DT (GCSE)	82.76%
Drama (GCSE)	77.78%
English (GCSE)	86%
Food and Nutrition (GCSE)	86.96%
French (GCSE)	75%
Geography (GCSE)	84.14%
German (GCSE)	93.33%
History (GCSE)	78.69%
Maths (GCSE)	81%
Media Studies (GCSE)	84.29%
Music (GCSE)	96.3%
PE (GCSE)	78.26%
Performing Arts (GCSE)	100%
Philosophy and Ethics (GCSE)	78.26%
Physics (GCSE)	100%
Science Double Award (GCSE)	68.28%
Spanish (GCSE)	82.43%



Percentage of pupils achieving the English Baccalaureate:

This measure shows the percentage of students achieving a 5+ or 4+ in English, Maths, two Sciences, a Language and either History or Geography.

Why grades 4 and 5?

The Government has set grade 4 as a 'standard pass' and grade 5 as a 'good pass.'

Why 8?

To ensure students receive a broad and balanced education, the Government encourages all students to study at least 8 subjects.



# ADMISSIONS INFORMATION

## Our Admissions Policy

Worthing High School is a 11-16 mixed comprehensive school and one of five secondary schools in the town of Worthing.

We became an Academy on 1 December 2012 and have a non selective policy.

The main principle of admission to Worthing High School is to maintain the character of the school as a comprehensive school with a calm and purposeful learning ethos, providing for the needs of young persons within the 11-16 age range, who live in Worthing and the surrounding areas.

There is no guarantee of a place for children living in this area in the case of oversubscription.

We are an inclusive school with a family feel and welcome all applications. Our uniform policy is intended to encourage a professional appearance and a pride in the school. We have tried to keep this at a reasonable cost while maintaining a level of conformity and are pleased to discuss any concerns you may have about uniform items.

Admission to our school is not dependent on any voluntary contribution and we have a full range of extra-curricular activities available for all students at no cost. We also have a full programme of both residential and non residential visits for which a charge is made but again are pleased to discuss any concerns you may have.

- Pupils will be admitted at the age of 11+ without reference to ability or aptitude.
- The admission number for September 2023 will be 210 for any year group.
- Mid year admissions into Years 8,9,10 and 11 will be dealt with in accordance with this policy.

**Our catchment area is the borough of Worthing.**

## How to apply:

<http://www.worthinghigh.net/admissions/>





# 2023 - OUR ADMISSIONS AREA

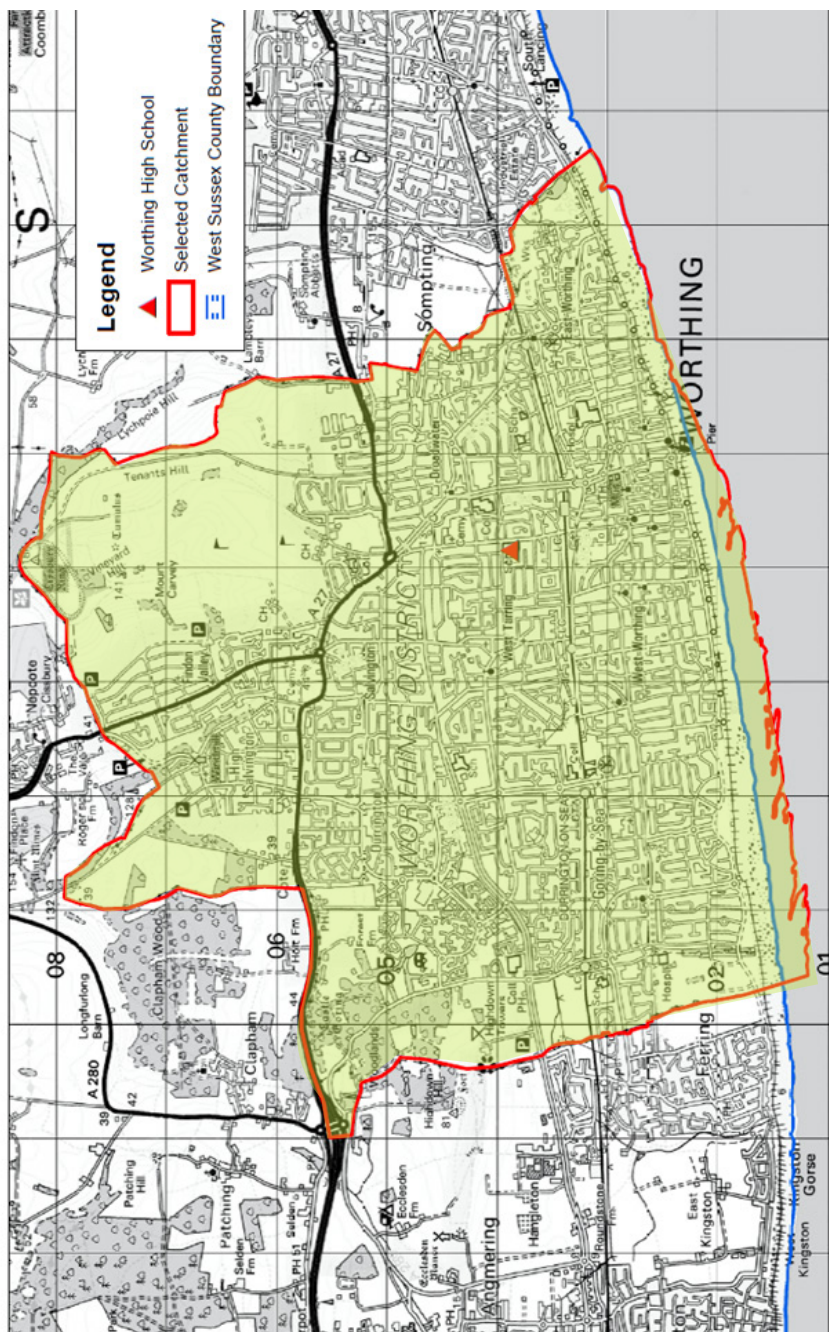

COMMUNITY – EXCELLENCE – RESILIENCE – INTEGRITY – RESPECT  
and WELLBEING

### **Worthing High School**

South Farm Road, Worthing, West Sussex, BN14 7AR

Tel: 01903 237864

Email: [office@worthinghigh.net](mailto:office@worthinghigh.net)

Website: [www.worthinghigh.net](http://www.worthinghigh.net)



Worthing High School is part of the South Downs Educational Trust

